

# Wooden furniture lock



**A-616S-22**  
Ø18mm



**A-616S-26**  
Ø18mm



**A-616S-32**  
Ø18mm



**A-616S-38**  
Ø18mm

**A-716S-22**  
Ø16.5mm

**RIM LOCK WITH BENT LATCH**  
(STANDARD VERSION)

## Specifications

- STANDARD VERSION RIM LOCK WITH BENT LATCH
- SUITABLE FOR SWING DOOR CABINET
- BENT LATCH ELIMINATES GAP BETWEEN DOORS
- AVAILABLE IN TWO DIAMETERS: 16.5mm & 18mm
- DIM. D = 25mm FOR SCREW MOUNTING
- CLICK ACTION MECHANISM
- KEY REMOVABLE IN LOCKED & UNLOCKED POSITIONS
- ZINC ALLOY DIE CAST

## A set includes

- 1 LOCK HOUSING
- 1 CYLINDER CORE
- 2 KEYS
- 1 BEZEL

## Accessories Options

- L-BRACKET
- STRIKE PLATE

## Dimensions

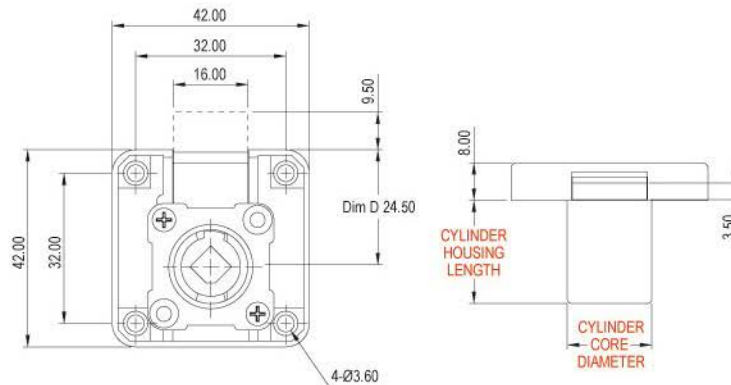

# Wooden furniture lock



**A-616L-22**  
Ø18mm



**A-616L-26**  
Ø18mm



**A-616L-32**  
Ø18mm



**A-616L-38**  
Ø18mm

**A-716L-22**  
Ø16.5mm

**RIM LOCK WITH BENT LATCH**  
(LEFT VERSION)

## Specifications

- LEFT VERSION RIM LOCK WITH BENT LATCH
- SUITABLE FOR SWING DOOR CABINET
- BENT LATCH ELIMINATES GAP BETWEEN DOORS
- AVAILABLE IN TWO DIAMETERS: 16.5mm & 18mm
- CLICK ACTION MECHANISM
- KEY REMOVABLE IN LOCKED & UNLOCKED POSITIONS
- ZINC ALLOY DIE CAST

## A set includes

- 1 LOCK HOUSING
- 1 CYLINDER CORE
- 2 KEYS
- 1 BEZEL

## Accessories Options

- L-BRACKET
- STRIKE PLATE

## Dimensions

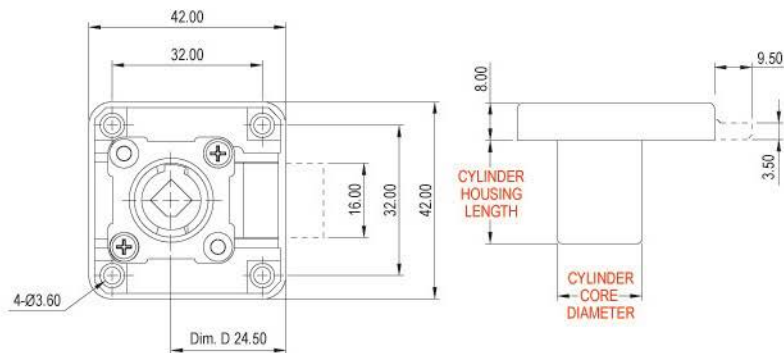



## Finished



SUITABLE FOR SWING DOOR CABINET  
BENT LATCH ELIMINATES GAP BETWEEN DOORS

## RIM LOCK WITH BENT LATCH

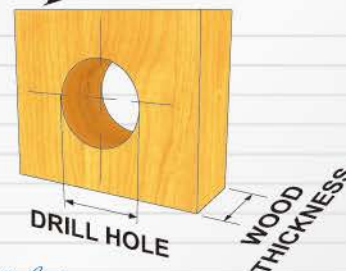

### Drill hole

Ø17.5mm FOR 16.5mm HOUSING DIAMETER  
Ø19mm FOR 18mm HOUSING DIAMETER

### Wood Thickness

16-20mm - USE 22mm CYLINDER HOUSING LENGTH  
20-24mm - USE 26mm CYLINDER HOUSING LENGTH  
24-30mm - USE 32mm CYLINDER HOUSING LENGTH  
30-36mm - USE 38mm CYLINDER HOUSING LENGTH

## Fixing Details

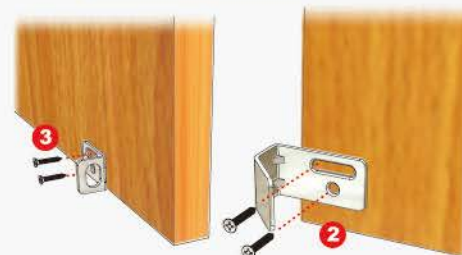
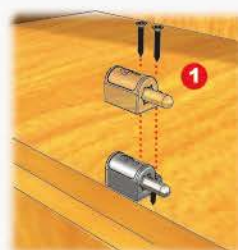
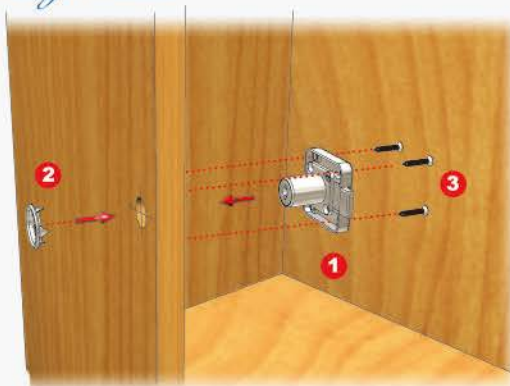

UPPER

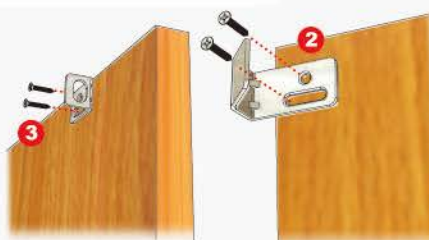
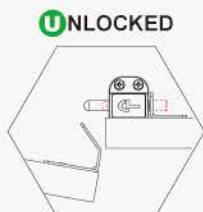
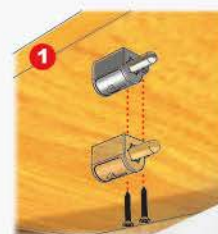

# Wooden furniture lock

*Finished*

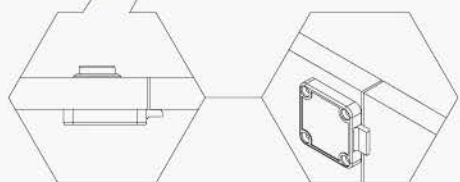

SUITABLE FOR SWING DOOR CABINET  
BENT LATCH ELIMINATES GAP BETWEEN DOORS

*Fixing Details*

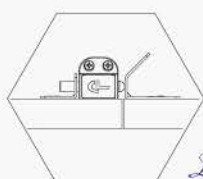
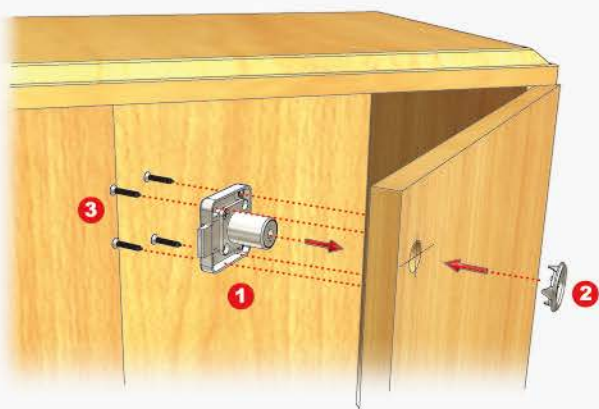

*Locked*

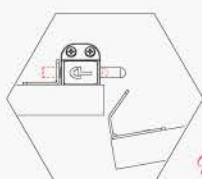

*Unlocked*

## DRAWER LOCK

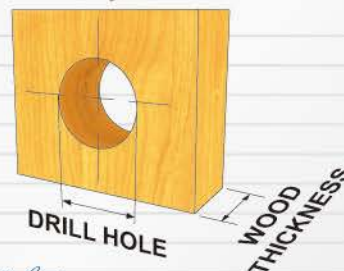

*Drill hole*

- Ø17.5mm FOR 16.5mm HOUSING DIAMETER
- Ø19mm FOR 18mm HOUSING DIAMETER

*Wood Thickness*

- 16-20mm - USE 22mm CYLINDER HOUSING LENGTH
- 20-24mm - USE 26mm CYLINDER HOUSING LENGTH
- 24-30mm - USE 32mm CYLINDER HOUSING LENGTH
- 30-36mm - USE 38mm CYLINDER HOUSING LENGTH

## AS-001-LOWER (AUTO LOCK BOLT)

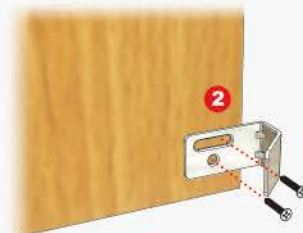
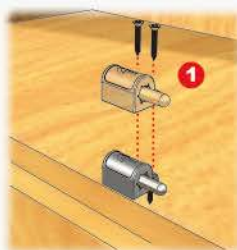

## Finished

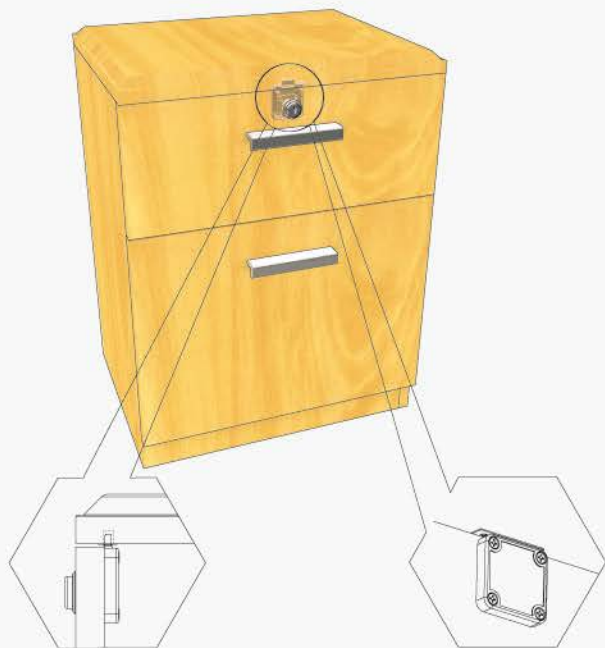

## DRAWER LOCK

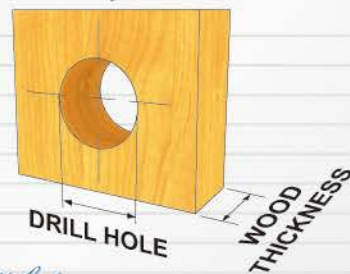

### Drill hole

- Ø17.5mm FOR 16.5mm HOUSING DIAMETER
- Ø19mm FOR 18mm HOUSING DIAMETER

### Wood Thickness

- 16-20mm - USE 22mm CYLINDER HOUSING LENGTH
- 20-24mm - USE 26mm CYLINDER HOUSING LENGTH
- 24-30mm - USE 32mm CYLINDER HOUSING LENGTH
- 30-36mm - USE 38mm CYLINDER HOUSING LENGTH

## Fixing Details

