

# Wooden furniture lock



**A-638H-22**  
Ø18mm

**A-738H-22**  
Ø16.5mm

**A-638V-22**  
Ø18mm

**A-738V-22**  
Ø16.5mm



**A-638H-26**  
Ø18mm

**A-738H-26**  
Ø16.5mm

**A-638V-26**  
Ø18mm

**A-738V-26**  
Ø16.5mm



**A-638H-32**  
Ø18mm

**A-738H-32**  
Ø16.5mm

**A-638V-32**  
Ø18mm

**A-738V-32**  
Ø16.5mm



## Specifications

- PUSH BAR LOCK
- AVAILABLE IN TWO VERSIONS :  
HORIZONTAL & VERTICAL
- CLICK ACTION MECHANISM
- KEY REMOVABLE IN LOCKED &  
UNLOCKED POSITIONS
- ZINC ALLOY DIE CAST

## A set includes

- 1 LOCK HOUSING
- 1 CYLINDER CORE
- 2 KEYS
- 1 BEZEL

## PUSH BAR LOCK

## Dimensions

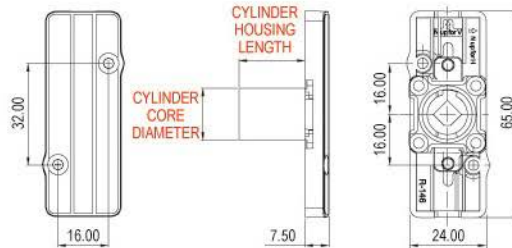

\* TO BE USED WITH  
VERTICAL VERSION ONLY

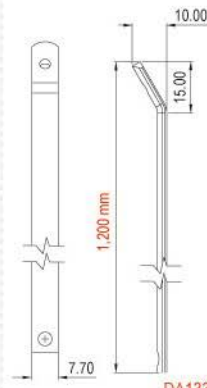
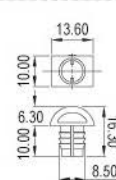
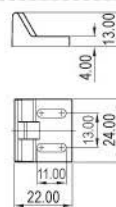

R149

R150

R147

DA133

# Wooden furniture lock

*Finished*



## PUSH BAR LOCK

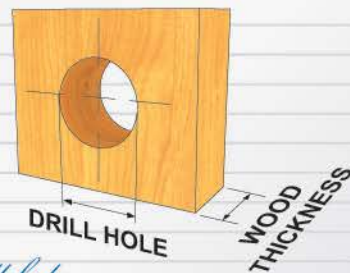

### *Drill hole*

- Ø 17.5mm FOR 16.5mm HOUSING DIAMETER
- Ø 19mm FOR 18mm HOUSING DIAMETER

### *Wood Thickness*

- 16-20mm - USE 22mm CYLINDER HOUSING LENGTH
- 20-24mm - USE 26mm CYLINDER HOUSING LENGTH
- 24-30mm - USE 32mm CYLINDER HOUSING LENGTH

### *Fixing Details*

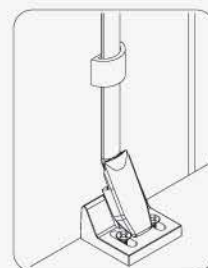
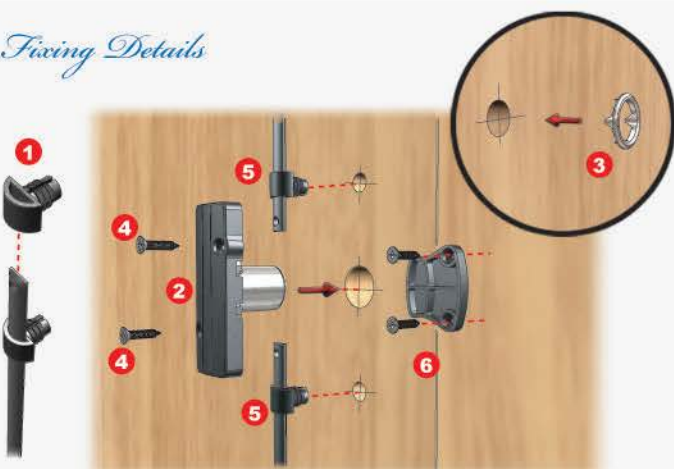

*Locked*



*Close*

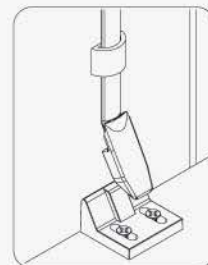

*Unlocked*

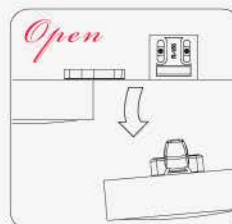

*Open*