

# Wooden furniture lock



**A-639H-22**  
Ø18mm

**A-739H-22**  
Ø16.5mm

**A-639V-22**  
Ø18mm

**A-739V-22**  
Ø16.5mm



**A-639H-26**  
Ø18mm

**A-739H-26**  
Ø16.5mm

**A-639V-26**  
Ø18mm

**A-739V-26**  
Ø16.5mm



**A-639H-32**  
Ø18mm

**A-739H-32**  
Ø16.5mm

**A-639V-32**  
Ø18mm

**A-739V-32**  
Ø16.5mm



## Specifications

- PUSH BAR LOCK
- AVAILABLE IN TWO VERSIONS :  
HORIZONTAL & VERTICAL
- CLICK ACTION MECHANISM
- KEY REMOVABLE IN LOCKED &  
UNLOCKED POSITIONS
- ZINC ALLOY DIE CAST

## A set includes

- 1 LOCK HOUSING
- 1 CYLINDER CORE
- 2 KEYS
- 1 BEZEL

## PUSH BAR LOCK

## Dimensions

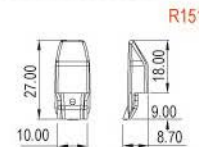
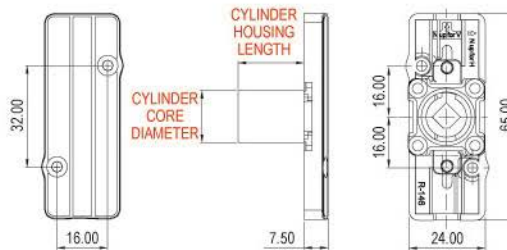

\* TO BE USED WITH  
VERTICAL VERSION ONLY

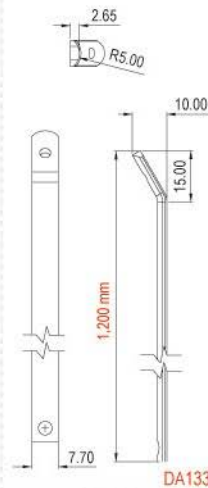
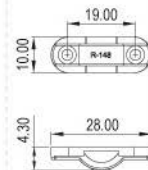
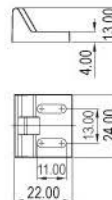

R149

R150

R148

DA133

# Wooden furniture lock



A-639H-22  
Ø 18mm  
A-739H-22  
Ø 16.5mm  
A-639V-22  
Ø 18mm  
A-739V-22  
Ø 16.5mm



A-639H-26  
Ø 18mm  
A-739H-26  
Ø 16.5mm  
A-639V-26  
Ø 18mm  
A-739V-26  
Ø 16.5mm



A-639H-32  
Ø 18mm  
A-739H-32  
Ø 16.5mm  
A-639V-32  
Ø 18mm  
A-739V-32  
Ø 16.5mm

## Finished

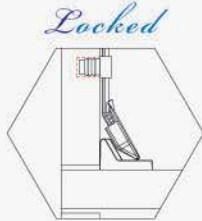

Locked

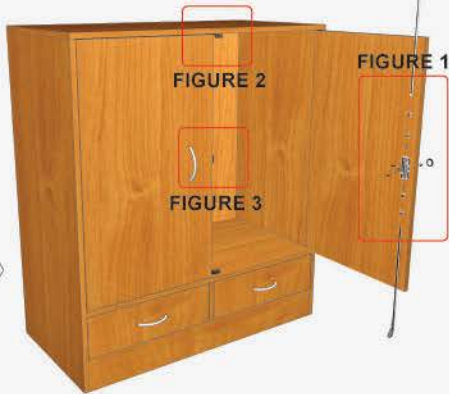
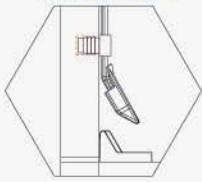

FIGURE 2

FIGURE 1

FIGURE 3

## Unlocked



## PUSH BAR LOCK

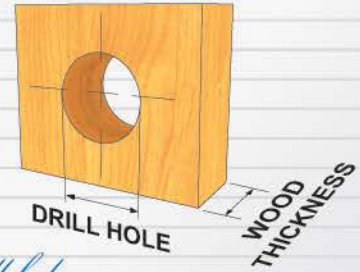

### Drill hole

- Ø 17.5mm FOR 16.5mm HOUSING DIAMETER
- Ø 19mm FOR 18mm HOUSING DIAMETER

### Wood Thickness

- 16-20mm - USE 22mm CYLINDER HOUSING LENGTH
- 20-24mm - USE 26mm CYLINDER HOUSING LENGTH
- 24-30mm - USE 32mm CYLINDER HOUSING LENGTH

## Fixing Details

FIGURE 1



FIGURE 2



FIGURE 3

