

Wooden furniture lock



A-730H-22-TYPE A
Ø16.5mm
A-730V-22-TYPE A
Ø16.5mm

PUSH BAR LOCK



Specifications

- PUSH BAR LOCK
- AVAILABLE IN TWO VERSIONS :
HORIZONTAL & VERTICAL
- CLICK ACTION MECHANISM
- KEY REMOVABLE IN LOCKED &
UNLOCKED POSITIONS
- ZINC ALLOY DIE CAST

A set includes

- 1 LOCK HOUSING
- 1 CYLINDER CORE
- 2 KEYS
- 1 BEZEL

Dimensions

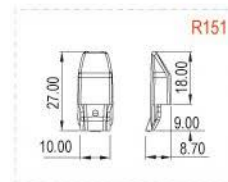
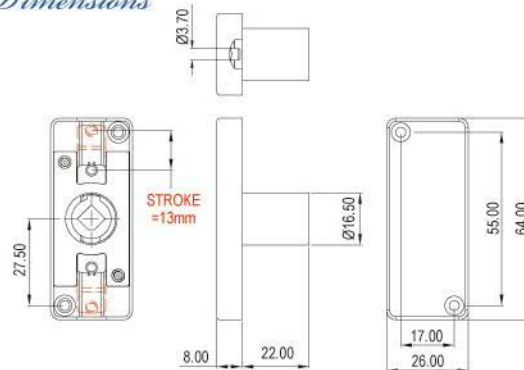

* TO BE USED WITH
VERTICAL VERSION ONLY

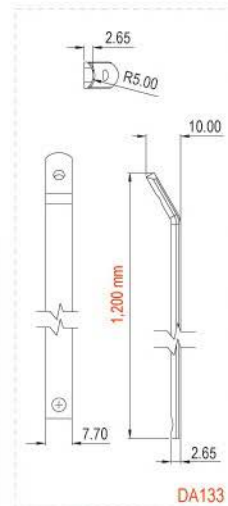
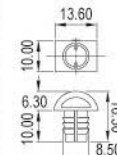
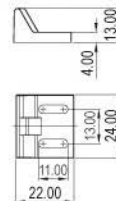

R149

R150

R147

DA133

Wooden furniture lock



A-730H-22-TYPE B
Ø16.5mm
A-730V-22-TYPE B
Ø16.5mm

PUSH BAR LOCK



Specifications

- PUSH BAR LOCK
- AVAILABLE IN TWO VERSIONS :
HORIZONTAL & VERTICAL
- CLICK ACTION MECHANISM
- KEY REMOVABLE IN LOCKED &
UNLOCKED POSITIONS
- ZINC ALLOY DIE CAST

A set includes

- 1 LOCK HOUSING
- 1 CYLINDER CORE
- 2 KEYS
- 1 BEZEL

Dimensions

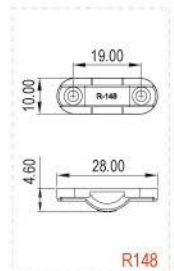
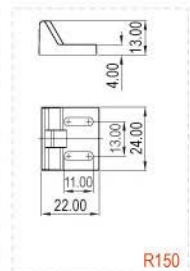
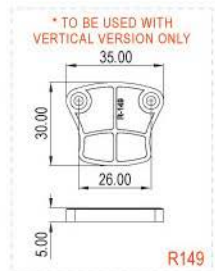
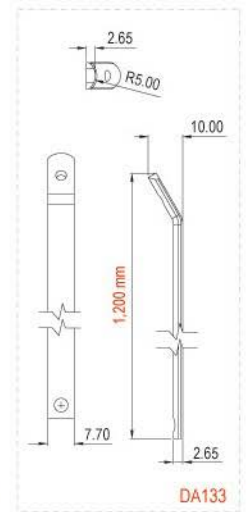
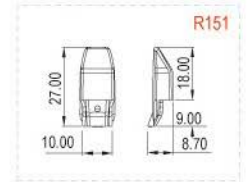
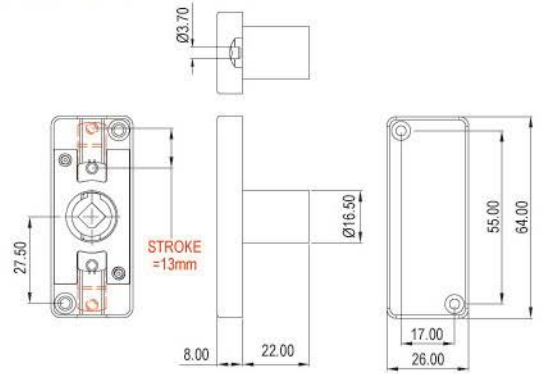

Wooden furniture lock

Finished



PUSH BAR LOCK

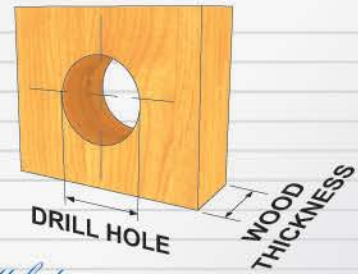

Drill hole

Ø17.5mm FOR 16.5mm HOUSING DIAMETER

Ø19mm FOR 18mm HOUSING DIAMETER

Wood Thickness

16-20mm - USE 22mm CYLINDER HOUSING LENGTH

20-24mm - USE 26mm CYLINDER HOUSING LENGTH

24-30mm - USE 32mm CYLINDER HOUSING LENGTH

Fixing Details

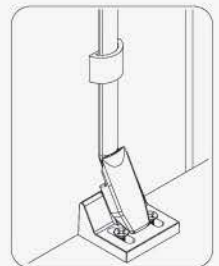
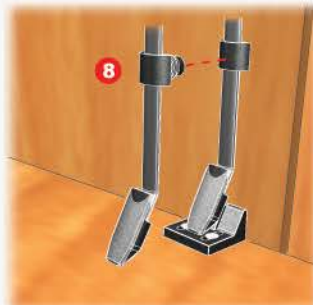
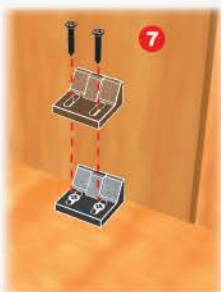
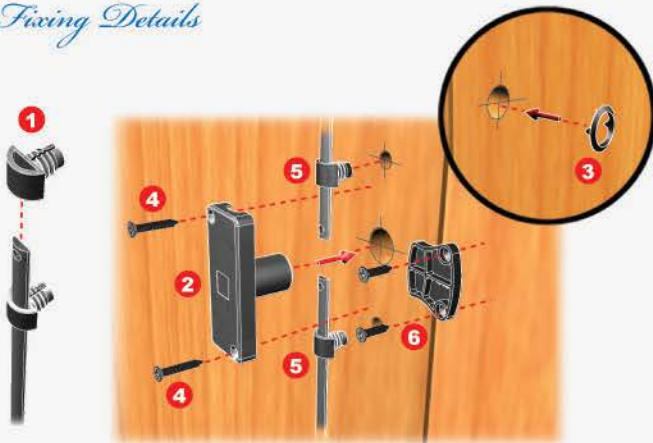

Locked



Close

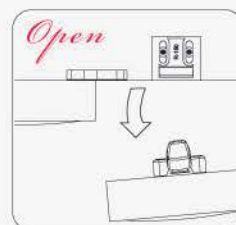

Open

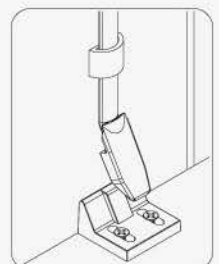

Unlocked